

TEMPORARY REVISION

AMM-TR-OÄM 40-316/C

Amendment to the R&I of the RACC Central Unit

This Temporary Revision AMM-TR-OÄM 40-316/C is approved in conjunction with the Optional Design Change Advisory OÄM 40-316 and is valid in conjunction with the Airplane Maintenance Manual (AMM) until this Temporary Revision has been incorporated into the AMM.

The limitations and information contained herein either supplement or, in the case of conflict, override those in the AMM.

The technical information in this document has been approved.

Doc. No	Section	Affected Pages
6.02.15	21-50-00	Page 201- 207
		Insert before Page 201.

Filing Instructions:

- Print this Temporary Revision and Cover pages on double sided 8.5 X 11 inch yellow paper.
- Insert the Cover pages before the first page of the Temporary Revision.
- Insert the seven pages of this Temporary Revision and the Cover pages in the AMM before page 201 of 21-50-00, as instructed in the Affected Pages column.
- Record the incorporation of this Temporary Revision on the yellow RECORD OF TEMPORARY REVISIONS sheet at the front of the manual.
- Keep this Temporary Revision until normal revision service incorporates the information into the DA 40 NG AMM.

Intentionally left blank

21-50 - MAINTENANCE PRACTICES

1. Remove/Install the RACC Central Unit

CAUTION THE EXTERNAL POWER UNIT MUST BE DISCONNECTED PRIOR TO THE REMOVAL OR INSTALLATION OF THE RACC CENTRAL UNIT. THIS IS NECESSARY TO PREVENT THE POSSIBILITY OF AN ELECTRICAL SHORT.

Refer to Figures 201, 202 and 203.

A. Remove the RACC Central Unit.

	Detail Steps/Work Items	Key Items/References
(1)	Remove the passenger seats.	Refer to Section 25-10.
(2)	Remove the seatbelt pulleys of the passenger seats.	Refer to Section 25-10.
(3)	Unplug the electrical connection of the cabin fan: <ul style="list-style-type: none"> - Open the baggage tray. - Unplug the electrical connector on the rear wall of the short baggage extension. 	
(4)	Remove the short baggage extension.	Refer to Section 25-10.
(5)	Remove short baggage extension fan and the drip tray.	
(6)	Remove the air ducts from the RACC central unit.	
(7)	Remove the metal air duct tube from the LH air outlet.	
(8)	Disconnect the electrical connections from the RACC central unit to: <ul style="list-style-type: none"> - Two 4AWG cables marked 24600C4 and 24413A6 (Cap and stow wires 24600C4 and 24413A6). - One 4AWG cable marked 24601A4N connected to the ground stud of the RACC central unit. - One plug coming from the RACC control panel. 	Electrically insulate wires 24600C4 and 24413A6 to prevent an electrical short while the RACC central unit is disconnected or removed.

	Detail Steps/Work Items	Key Items/References
(9)	Remove the four bolts which connect the mounting panel of the RACC central unit to the mounting panel supports.	
(10)	Slide the RACC central unit forward.	
(11)	Lift the RACC central unit clear of the airplane.	

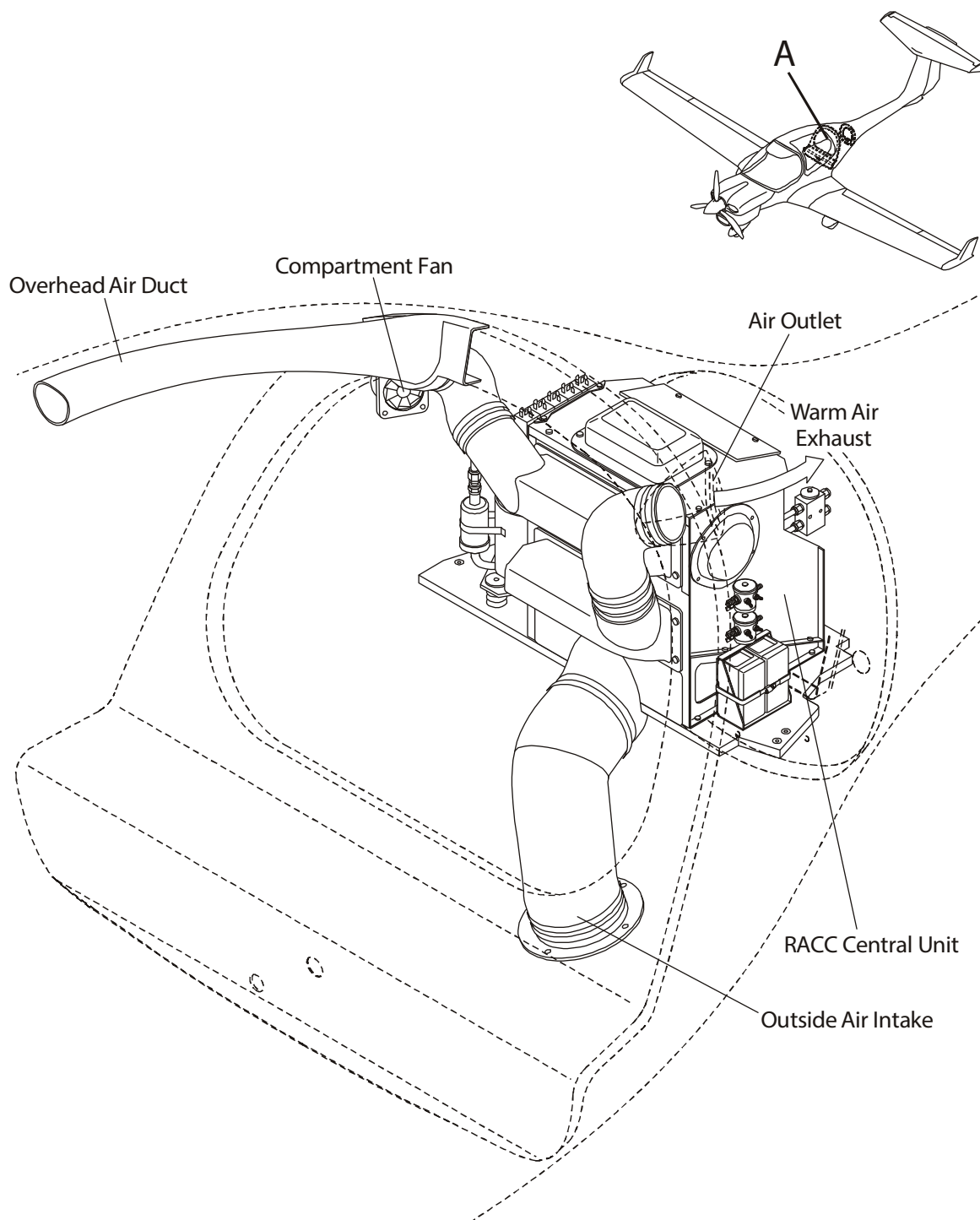
**Figure 201 : RACC Central Unit Installation**

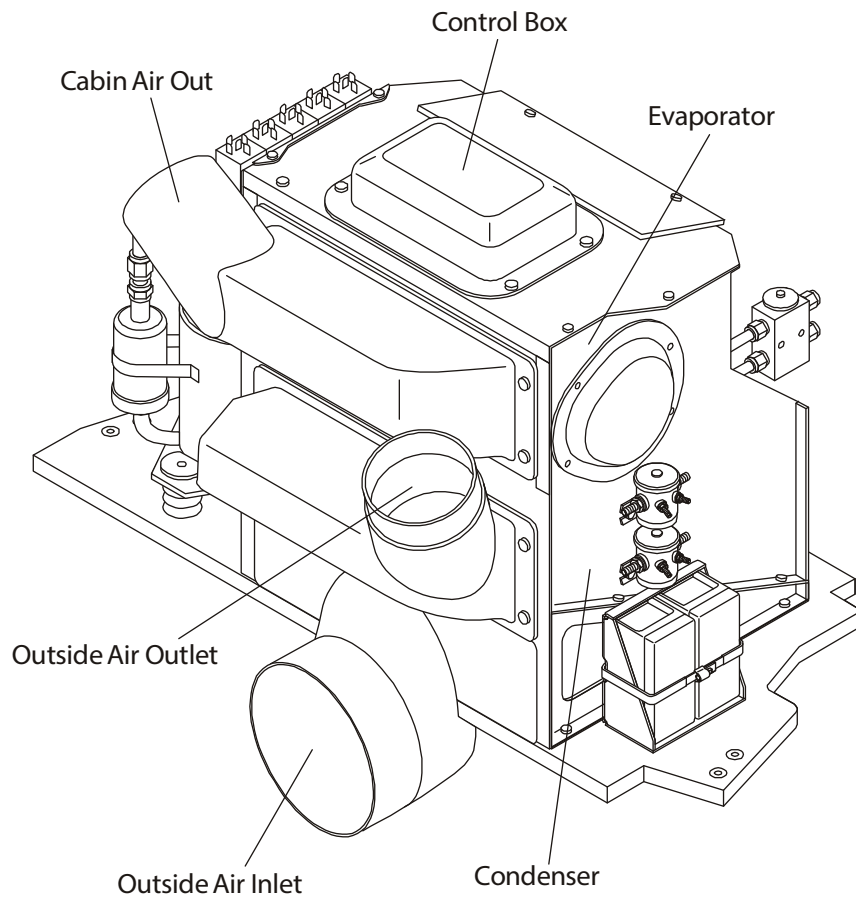
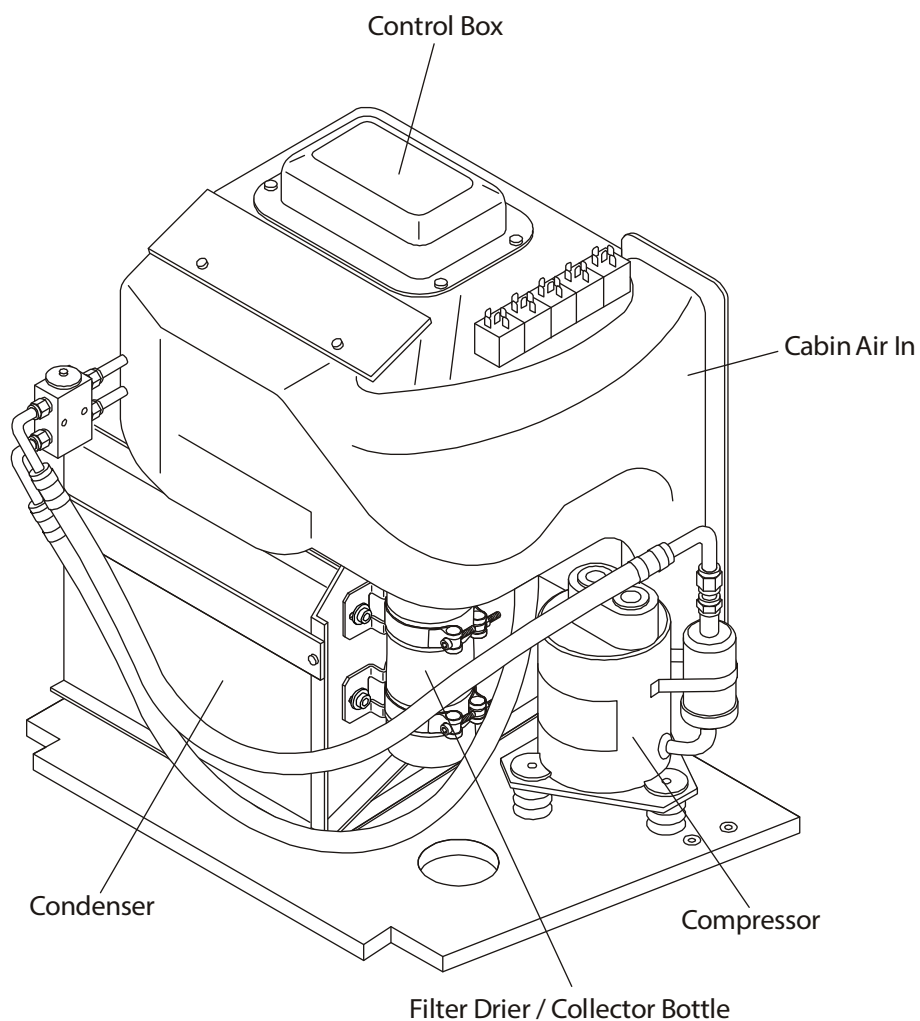

Figure 202 : Central Unit - Front and LH Side

**Figure 203 : Central Unit - Back and RH Side**

B. Install the RACC Central Unit.

	Detail Steps/Work Items	Key Items/References
(1)	Lift the RACC central unit into the airplane.	
(2)	Slide the RACC central unit backward. Make sure to position the mounting panel on the mounting panel supports in the fuselage.	
(3)	Install the four screws which connect the mounting panel of the RACC central unit to the mounting panel supports.	
(4)	<p>Connect the electrical cables to the RACC central unit to:</p> <ul style="list-style-type: none"> - Three 4AWG cables marked 24600C4, 24413A6 and 24601A4N - One plug coming from the RACC control panel. 	<p>Remove the electrically insulating material from the 4 AWG cables marked 24600C4 and 24413A6 and connect them to the terminal block of the RACC central unit.</p> <p>Connect the other 4 AWG cable marked 24601A4N to the ground stud of the RACC central unit.</p>
(5)	Install the metal air duct tube to the RH air outlet.	
(6)	Install the air ducts on the RACC central unit.	
(7)	Install the short baggage extension fan and the drip tray.	
(8)	Position the short baggage extension in front of the RACC central unit.	
(9)	Connect the air duct of the RACC central unit to the short baggage extension.	
(10)	Install the short baggage extension.	Refer to Section 25-10.
(11)	<p>Connect the cabin fan electrically:</p> <ul style="list-style-type: none"> - Open the baggage tray. - Plug in the electrical connector on the rear wall of the short baggage extension. 	

	Detail Steps/Work Items	Key Items/References
(12)	Install the seatbelt pulleys of the passenger seats.	Refer to Section 25-10.
(13)	Install the passenger seats.	Refer to Section 25-10.
(14)	Perform a cooling test of the RACC system.	